

# BYOxV2 - How to Guide

## iOS – Getting your BYO device ready for school

v1.4

Department of Education

This document explains how to:

- [enrol a BYO device into Intune](#) at home (A BYO device is owned by you and not the school)
- [install an app](#) on your device.
- [set up EQ mail account](#) to send / receive using Mail app

Once you have enrolled your device into Intune, you will be able to install school learning applications and access school email.

### Notes

These instructions are for iPads:

- owned by students (BYO)
- using version 12.2+ of iOS.

A passcode or password must be set on the iPad to complete the device enrolment. This protects your device and data.

If during the enrolment process, the Intune company portal app closes, open it and try again.

## Enrolling your device into Intune

### Step 1. Check your internet connection

- a. Test that you are connected to your home Wi-Fi by tapping the **Safari** icon



- b. Search for something, for example, Queensland schools.

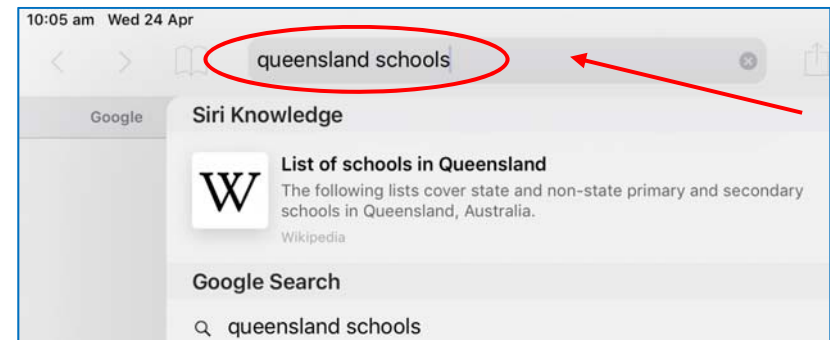

- c. If your search was successful, then the internet is working, and you can continue.

Note: If you cannot enrol your device at home, ask your school for assistance.





# BYOxV2 - How to Guide

## iOS – Getting your BYO device ready for school

### Step 2. Install Intune

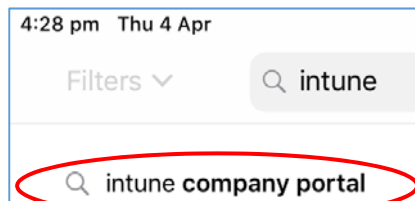
- Tap the **App Store**  icon.
- Type Intune in the search bar and tap **intune company portal**.



- Either tap **Get** or  to get the Intune company portal installed on your device.

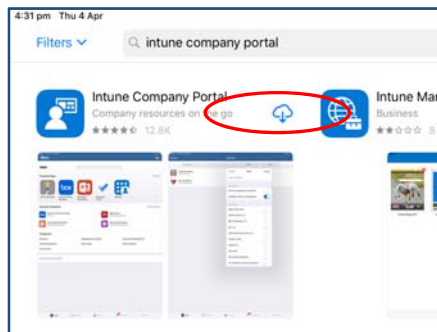

Once installed, Intune is named “Comp Portal” on your device.

### Step 3. Sign in to Microsoft Intune

- Open the Microsoft Intune **Comp Portal** app.



- The Company Portal **Welcome** screen will display. You may need to tap **Sign in** to continue.

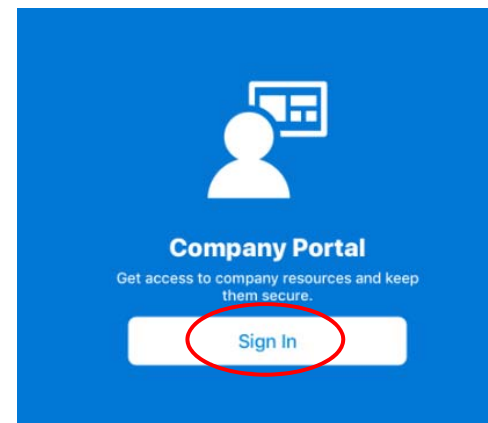

# BYOxV2 - How to Guide

## iOS – Getting your BYO device ready for school

- c. Enter your Education Queensland @eq.edu.au email address, then tap **Next**.

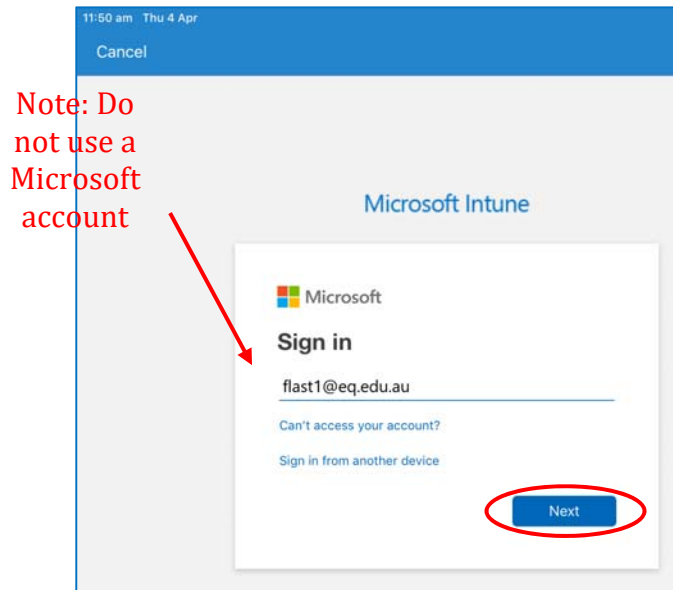

- d. Wait for the sign in page.

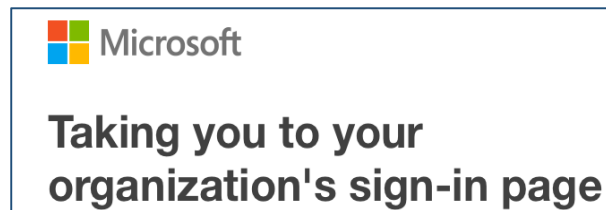

### Step 4. Enter user name and password

- a. The user name is auto filled. It is the first part of your school email address **username**@eq.edu.au. Enter your school password.
- b. Accept the terms and conditions and tap **Sign in**.

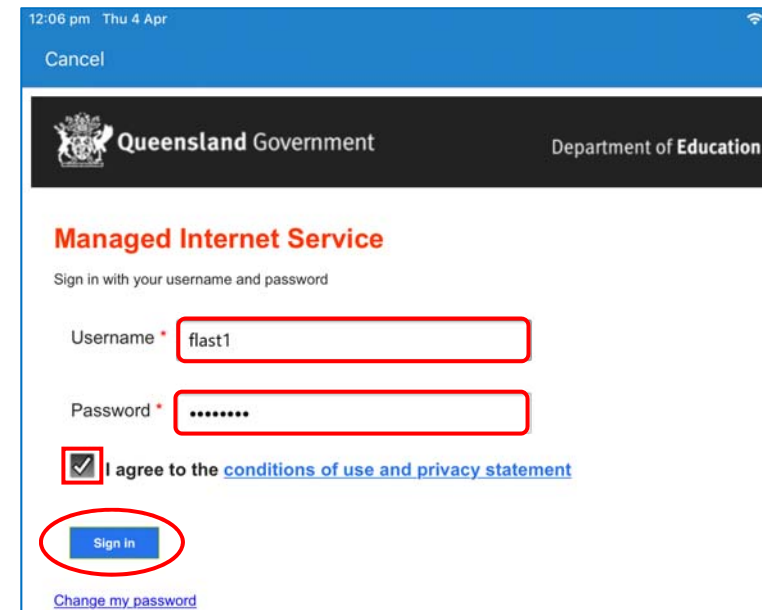

# BYOxV2 - How to Guide

## iOS – Getting your BYO device ready for school

v1.4

Department of Education

### Step 5. Install management profile

a. Tap **Begin**.

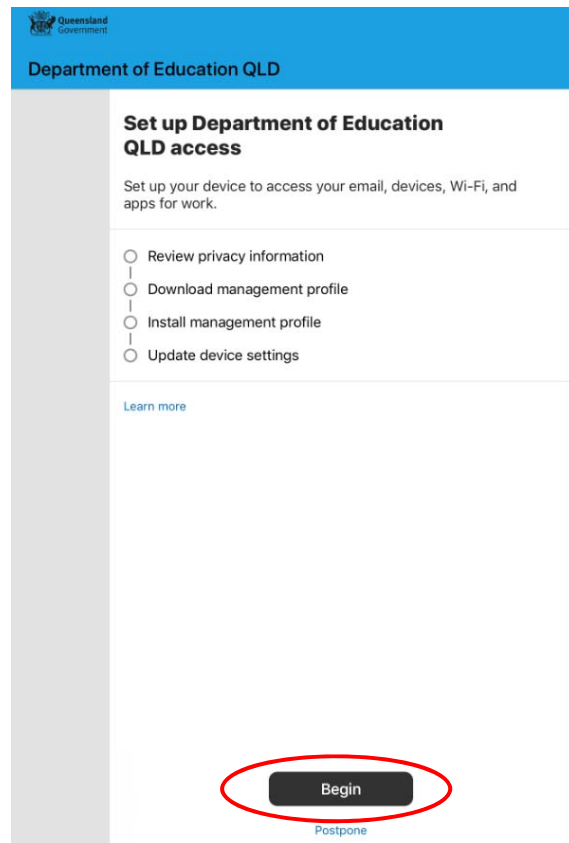

b. See a list of what your IT administrator can or can't see on your enrolled device. Tap **Continue**.

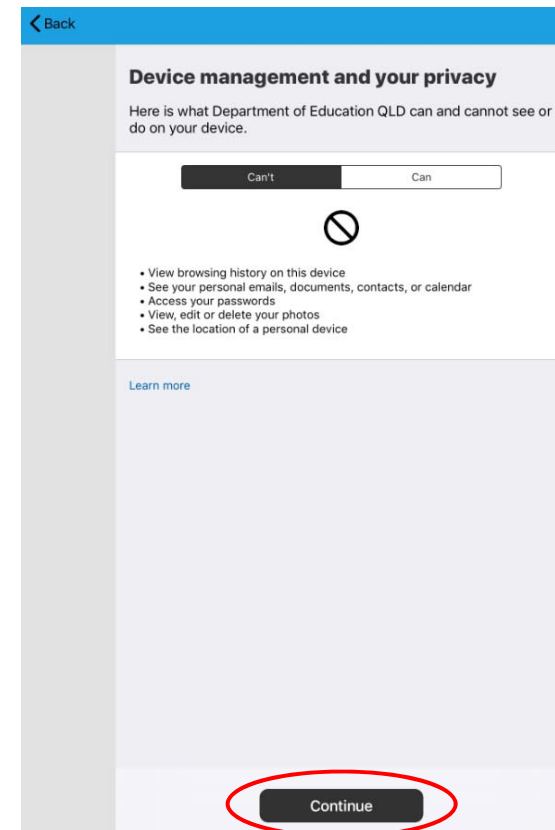

# BYOxV2 - How to Guide

## iOS – Getting your BYO device ready for school

v1.4

Department of Education

c. Details of what's next are displayed. Tap **Continue**.

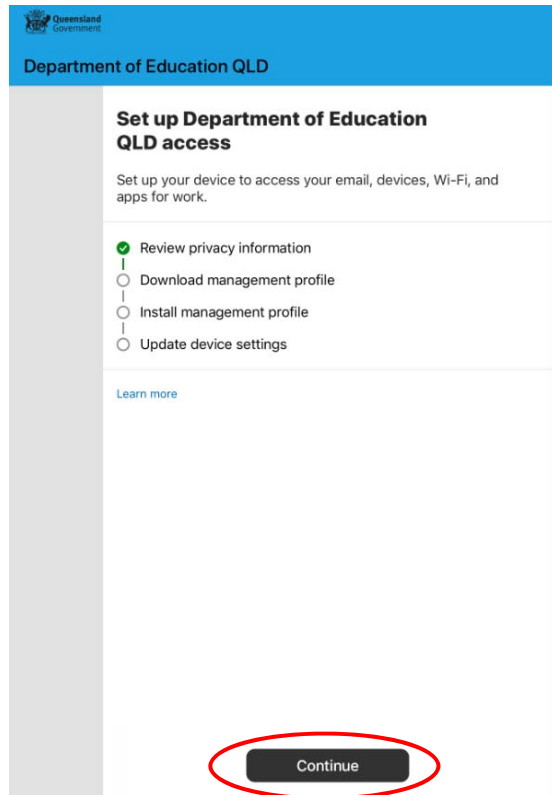

(If the **What's next** display on your screen looks different from the one above, then you may be on a different version of iOS. Tap **Continue** and then **Allow** and go to **step j** on page 7 to install the management profile.)

d. Tap **Allow** to download a management profile.

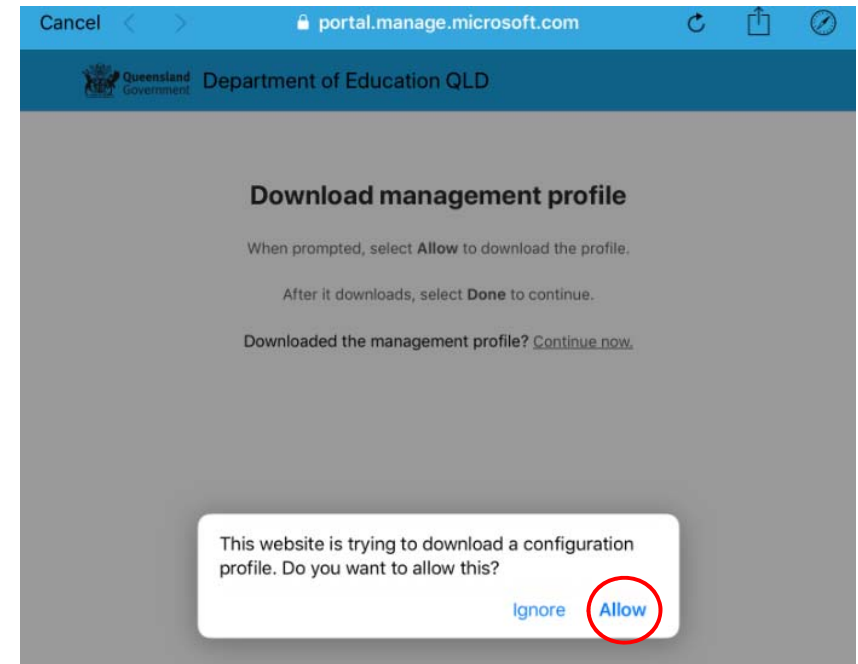

# BYOxV2 - How to Guide

## iOS – Getting your BYO device ready for school

v1.4

Department of Education

- e. Profile has been downloaded. Tap **Close**.

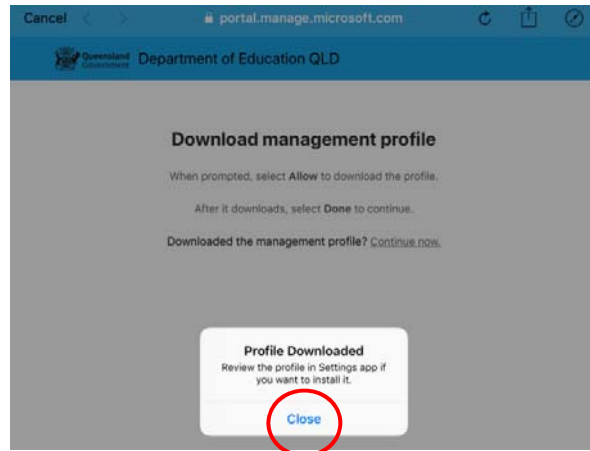

- f. Tap **Continue now** and **Continue** in the next page to continue.

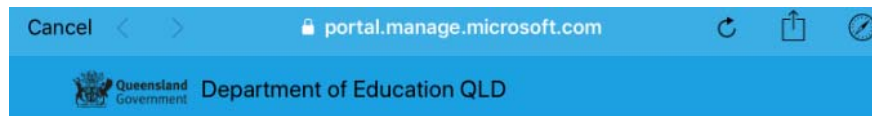

### Download management profile

When prompted, select **Allow** to download the profile.

After it downloads, select **Done** to continue.

Downloaded the management profile: [Continue now](#)

- g. A screen is displayed, providing instructions on installing the profile. Press the home button to minimize this window. If you are using an iPad pro, slide up from the bottom of the screen to go to home screen.

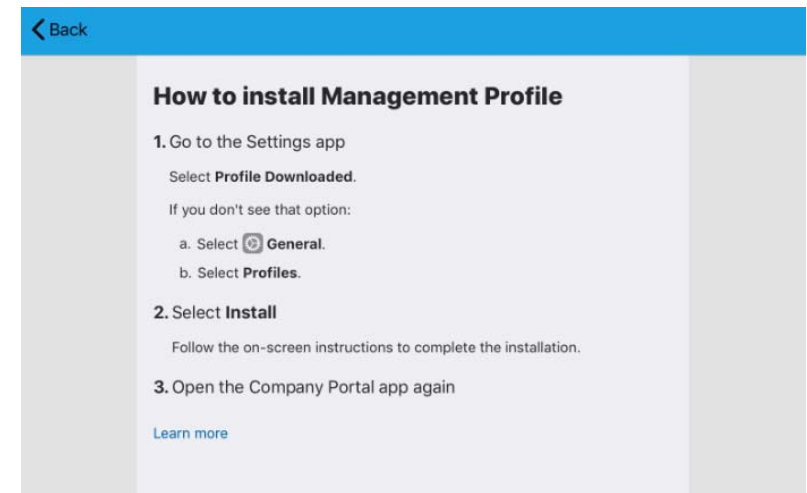

- h. Open the settings by tapping the settings  icon.  
i. Enter your password if requested.



# BYOxV2 - How to Guide

## iOS – Getting your BYO device ready for school

j. Tap **Profile Downloaded**.

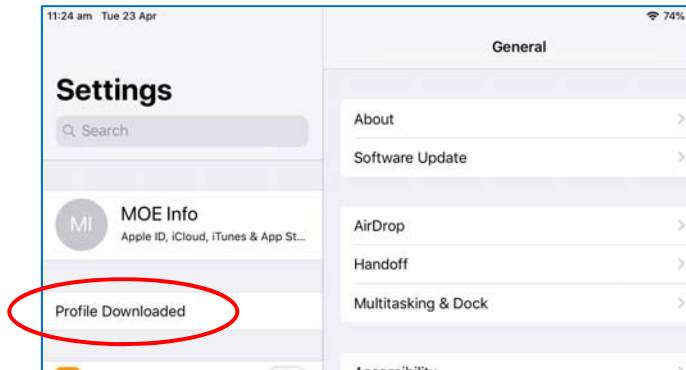

l. If prompted, enter your device passcode.

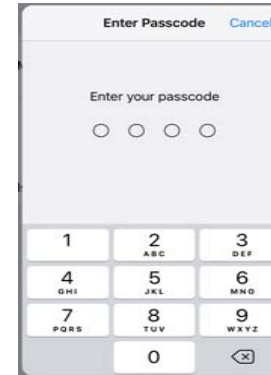

k. On the install profile screen, tap **Install**.

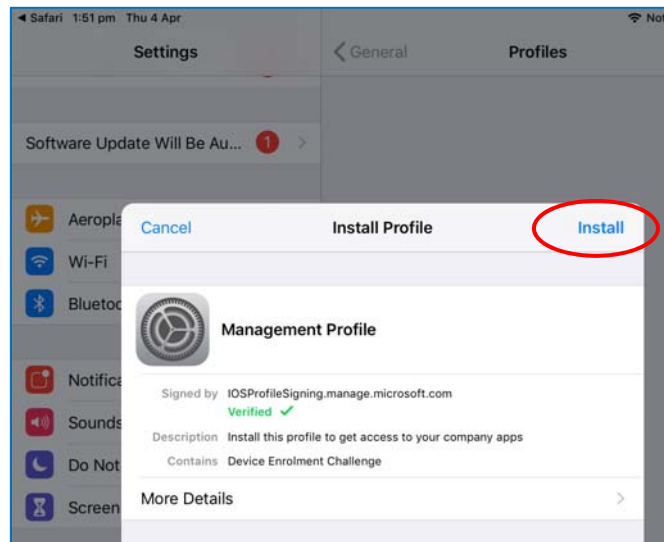

m. On the install profile popup, tap **Install**.

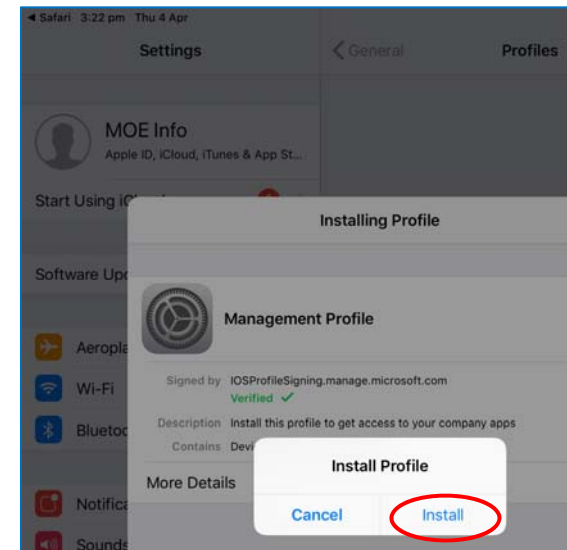

# BYOxV2 - How to Guide

## iOS – Getting your BYO device ready for school

v1.4

Department of Education

- n. A standard system warning is displayed. To continue with installation, tap **Install**.

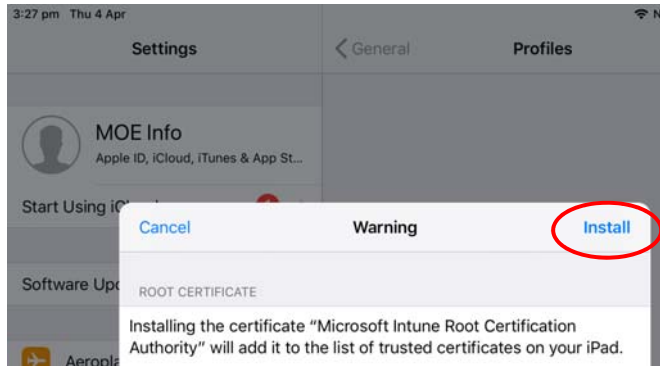

- o. If you are prompted to trust remote management, tap **Trust**.

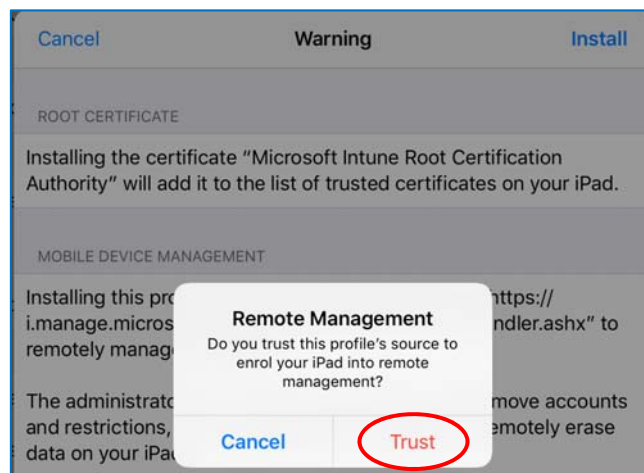

- p. When the screen changes to show that the profile has finished installing, tap **Done**. An "Enrolling device" message displays on the screen.

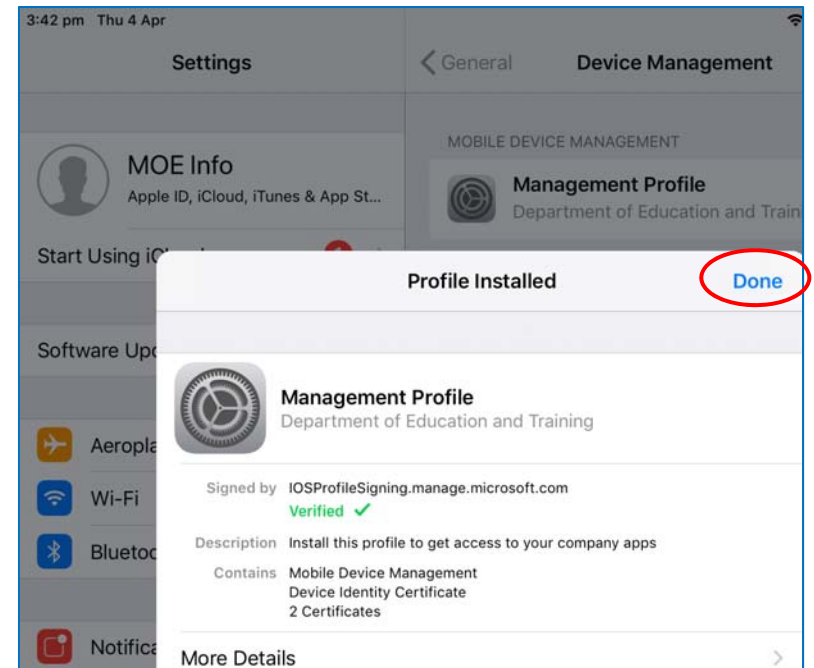



# BYOxV2 - How to Guide

## iOS – Getting your BYO device ready for school

v1.4

Department of Education

### Step 6. Configure device settings

- a. The Settings page will be displayed. Notice under Device Management, the management profile has been installed. Press the home button to minimise the settings window.

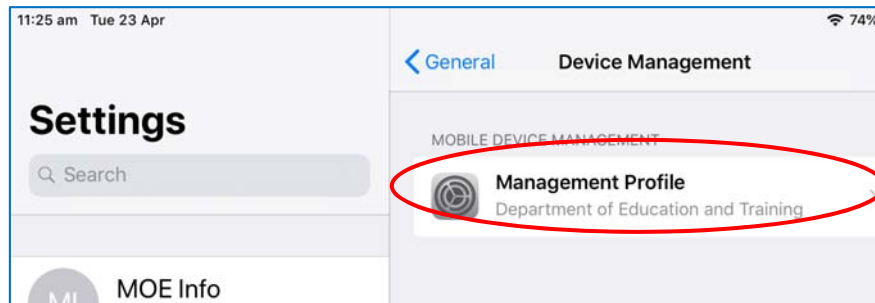

Note: If you are presented with a pop-up asking whether you want to open in company portal, instead of the screen above, you may be on an older version of iOS. In this case, tap **Open** and then tap **Continue** and go to step c.

- b. Tap **Comp Portal** and return to the company portal app again, and then tap **Continue** in the next page to continue.

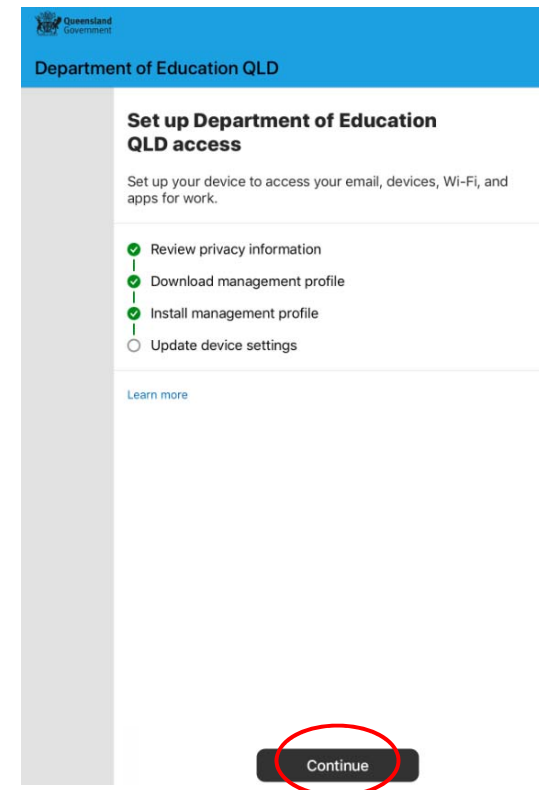

# BYOxV2 - How to Guide

## iOS – Getting your BYO device ready for school

v1.4

Department of Education

c. A message will display while you wait.

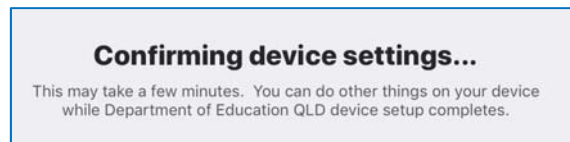

d. Your device is now managed through the Company Portal. Select **Done** to complete the setup.

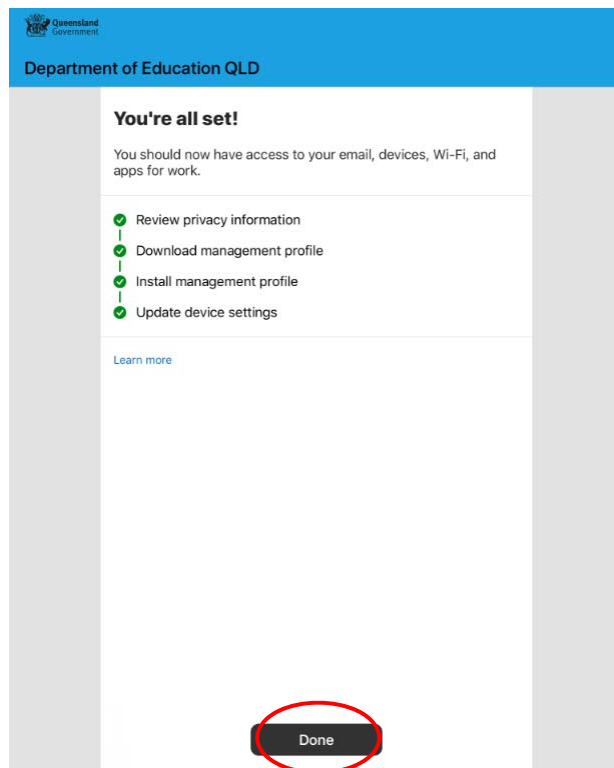

e. You may be asked for permission for Company Portal to send you notifications. Select **Ok** then **Allow**.

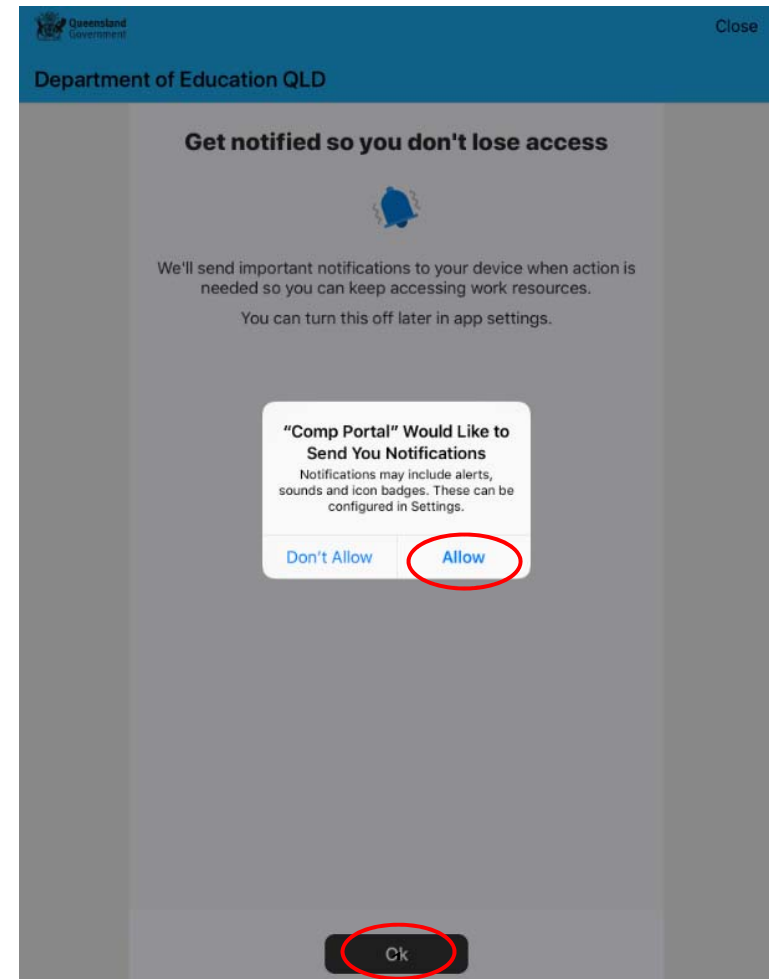

10



# BYOxV2 - How to Guide

## iOS – Getting your BYO device ready for school

v1.4

Department of Education

- f. A greeting screen is displayed when enrolment is done.

*You can now use your iPad for other purposes, but keep the device connected to the internet for 15 minutes for installation to complete.*

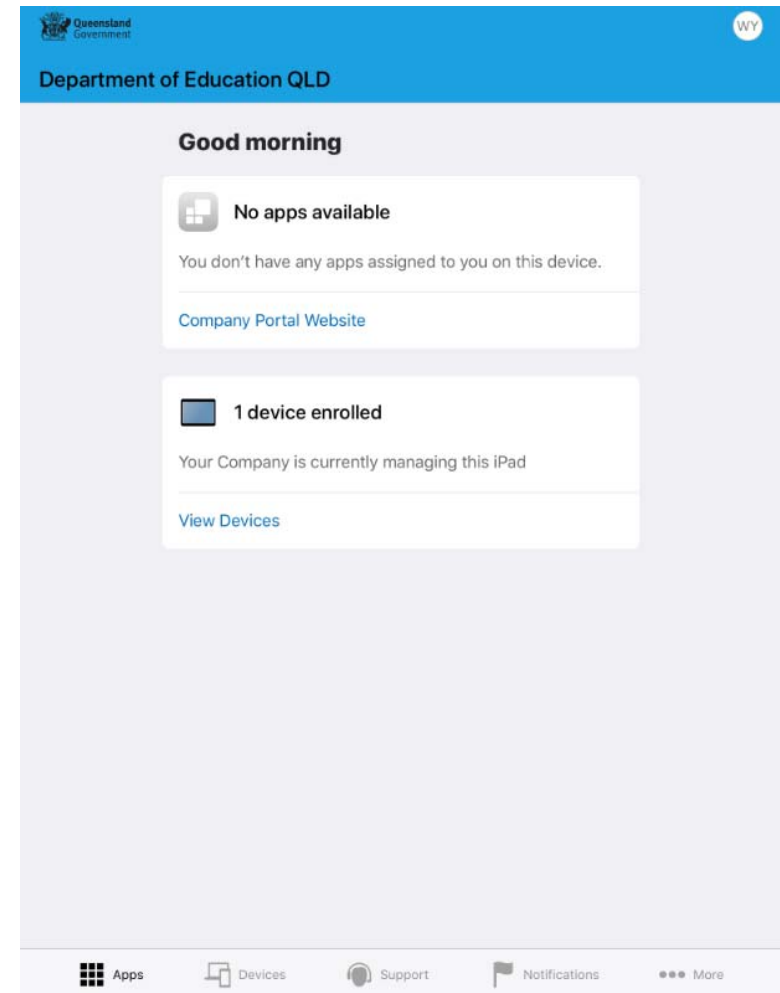

### Install an app

- a. Following enrolment, the Company Portal will display recently published apps. Tap **View All Apps** to see the full list of apps available to install.

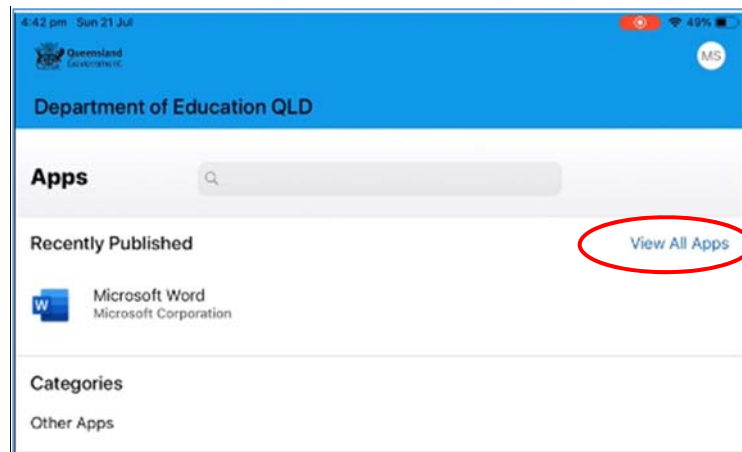

- b. Tap the app which you want to install, for example, **Microsoft Word**.

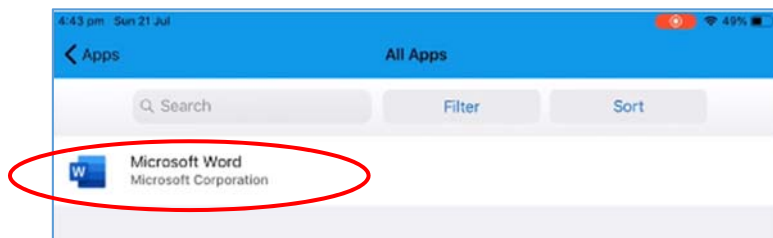

- c. Information about the app will be displayed. Tap **Install**.

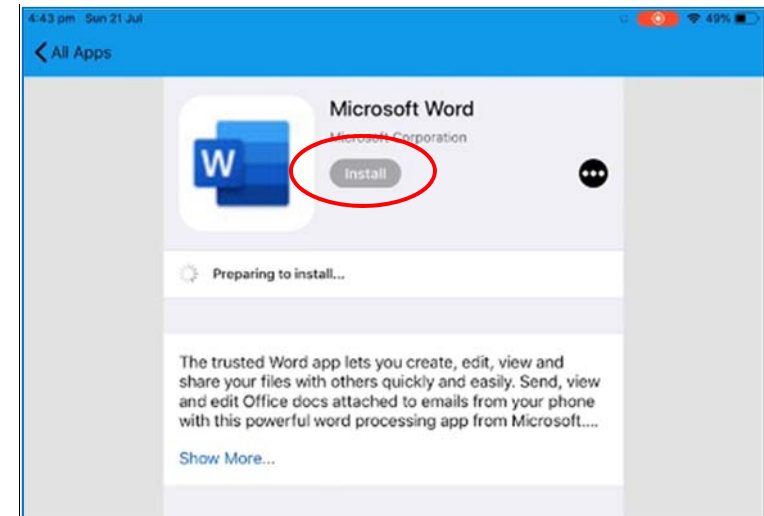

- d. A confirmation screen will be displayed. Tap **Install**.

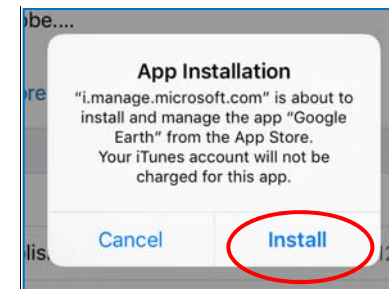

# BYOxV2 - How to Guide

## iOS – Getting your BYO device ready for school

v1.4

Department of Education

- e. Press home to minimise the company portal window or if using an iPad pro, swipe up from the bottom of the screen and select home screen. See if the app you downloaded is available for use. Sometimes the status shows downloading or pending, but the app is installed.

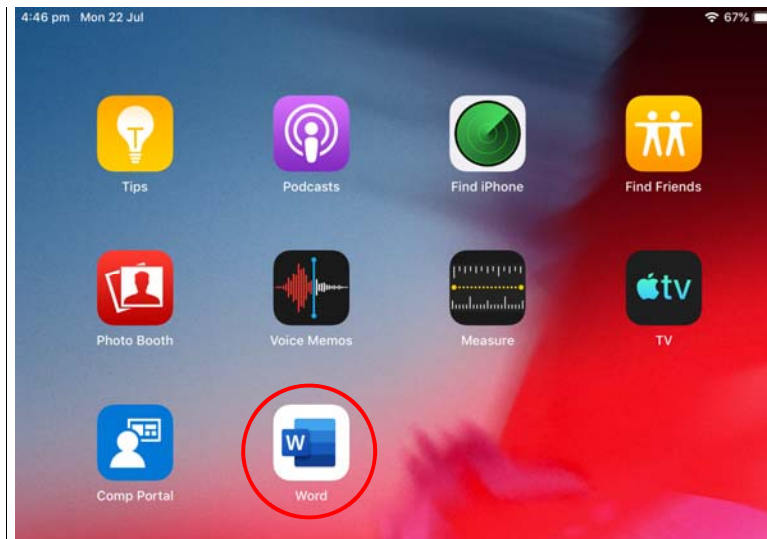

## Set up EQ mail account

- a. When opening Settings for the first time after successful device enrolment, a pop-up is displayed asking for School Email password. Enter your EQ password.

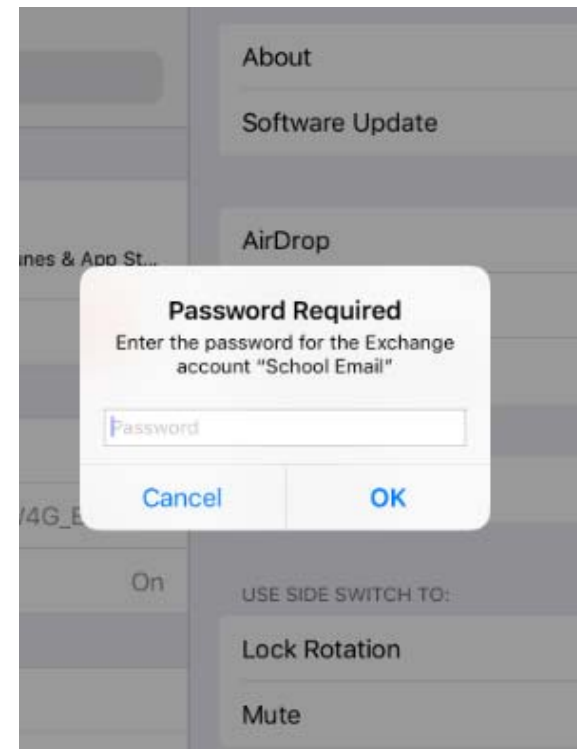

# BYOxV2 - How to Guide

## iOS – Getting your BYO device ready for school

- b. If the initial pop-up is cancelled accidentally, the user can fill in the password by following below steps:
- c. Tap **Passwords and Accounts** and **School Email**.

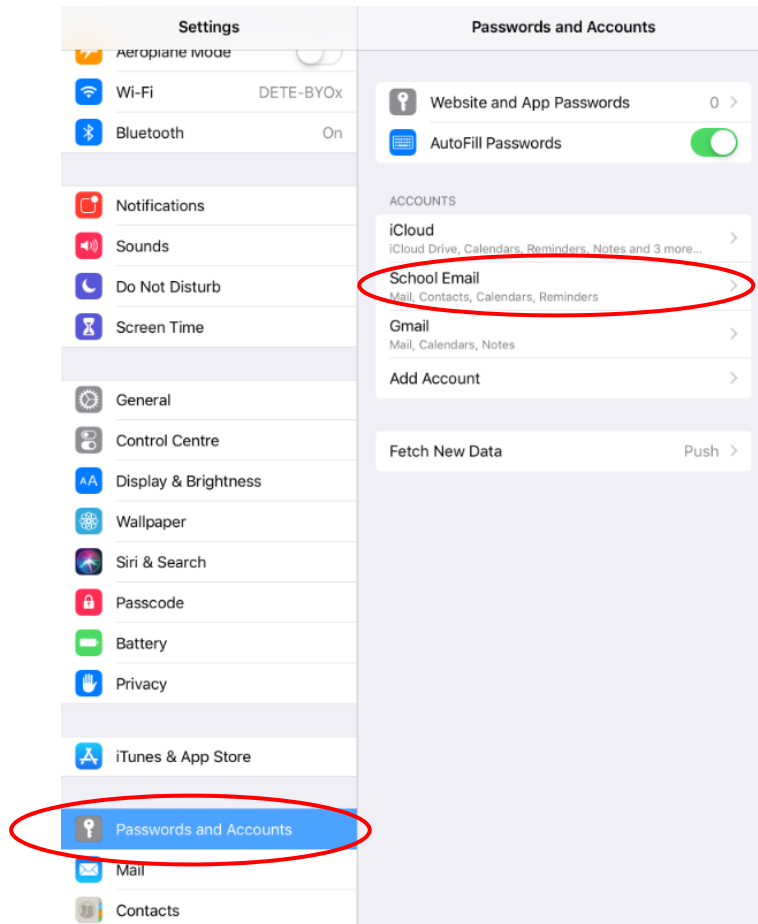

- d. Tap **Account**.

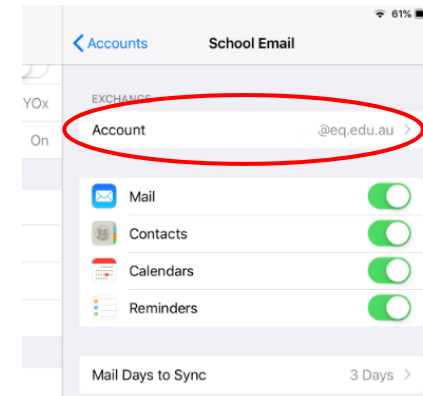

- e. Enter EQ password and tap **Done**.

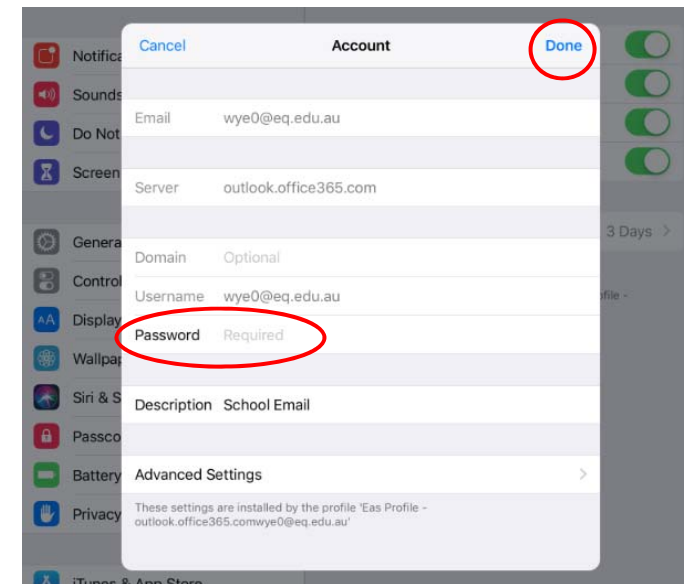

## Helpful Resources

### Microsoft User Guides

---

Note: Microsoft has user guides and help documents for using Intune. Some of the links and documents below are Microsoft documents and the school or Education Department is referred to as a “company”.

### Helpful Links

---

1. [What happens when you enrol your device with Intune?](#)
2. [What happens if you un-enrol your device from Intune?](#)
3. [Intune iOS Enrolment Instructional Video](#)

### Things you can do when your device is enrolled in Intune

---

- [Un-enrol your device from Intune](#)

**Note:** when you un-enrol, you will lose any apps installed through Intune and the data inside these apps.

- [Reset \(erase\) your lost or stolen device](#)

